



DENALI Plow Mount

MA11199

Universal ATV Plow Mount

Patent #: US8505973B2

Thank you for purchasing our DENALI plow mount. You now own a premium custom plow mount to allow you to use your plow with your ATV. Please note the following instructions and heed all warnings.

- Your ATV and/or plow system can cause death or injury, please use caution and common sense when operating your unit.
- Read your Plow Operator Manual, your Winch Operator Manual, and all warning labels before operating your ATV.
- Operate your ATV at a walking speed with the blade installed. Do not exceed 5 mph (8 km/h), even with the blade up.
- Do not operate the ATV on slopes greater than 10 degrees with the plow installed.
- Always lower the plow to the down position before leaving your ATV unattended.

SEVERE INJURY OR DEATH MAY RESULT IF YOU ARE NEGLIGENT.

DENALI Universal ATV Plow Mount

Patent #: US8505973B2



motoalliance

22000 Industrial Blvd

Rogers, MN 55374

866.527.7637

Please verify that all hardware and parts are included in your package.

Kit Contents:

| Item # | Qty | Description |
|--------|-----|----------------------------------|
| 1 | 1 | MA11199-1 Plow Mount |
| 2 | 4 | MA11199-3 1.875" Mounting Tab |
| 3 | 4 | MA11199-4 2.125" Mounting Tab |
| 4 | 4 | MA11199-5 2.375" Mounting Tab |
| 5 | 4 | 3/8" x 1.50" ID U-Bolt -3043T632 |
| 6 | 4 | 3/8" x 1.75" ID U-Bolt -3043T633 |
| 7 | 4 | 3/8" x 2.00" ID U-Bolt -3043T634 |
| 8 | 8 | 3/8" Serrated Flange Nut |

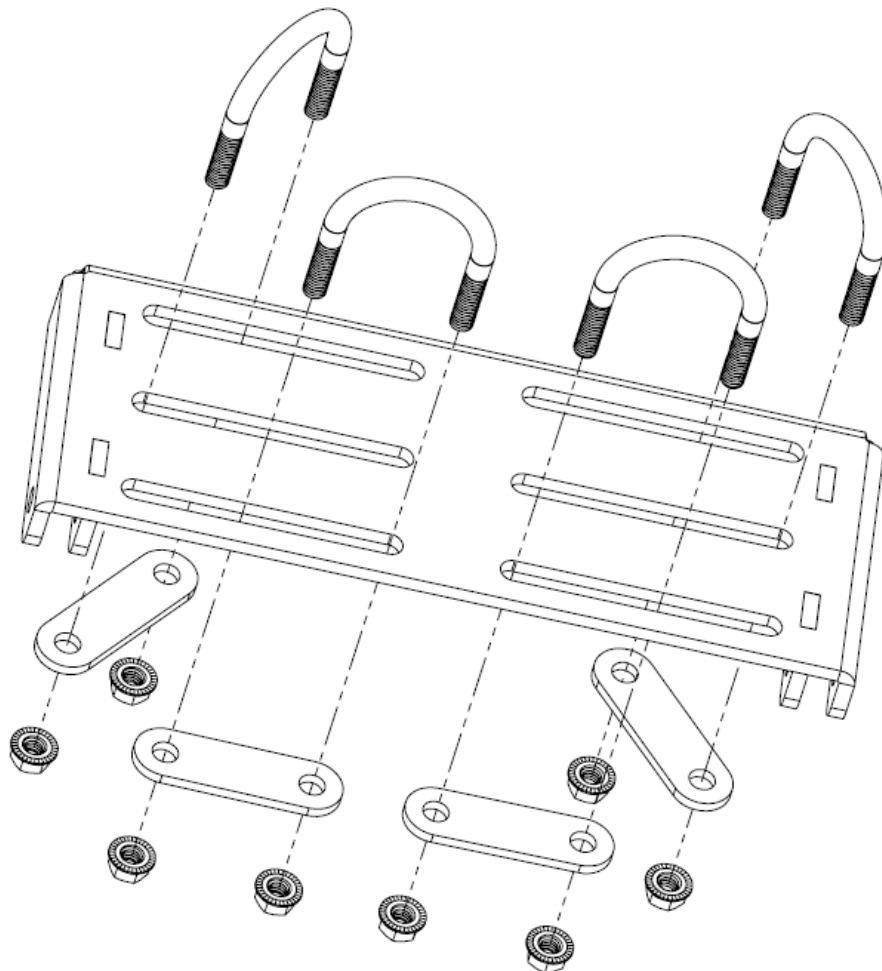

DENALI Universal ATV Plow Mount

Patent #: US8505973B2



motoalliance

22000 Industrial Blvd

Rogers, MN 55374

866.527.7637

Tips for installation:

Begin by removing the skid plate from your vehicle.

When installing the Denali Universal Plow Mount, the mount should be placed approximately 2 feet from the front of the vehicle.

Included in your kit are three sizes of U-bolts, use the set that most securely fits around the frame of your vehicle, it may be necessary to mix and match sizes.

Ideally two U-bolts will be used to secure the mount front to back and the other two secure the mount side to side. **Note: See the pictures below for possible frame/mount orientations.**

If you want to reinstall the skid plate:

After the mount is correctly secured, lift the skid plate into place and mark the location of the U-bolts in the skid plate and drill the holes out.

Remove the mount plate and reinstall the skid plate. Hang the U-bolts over the frame and through the skid plate. Reinstall the mount plate.

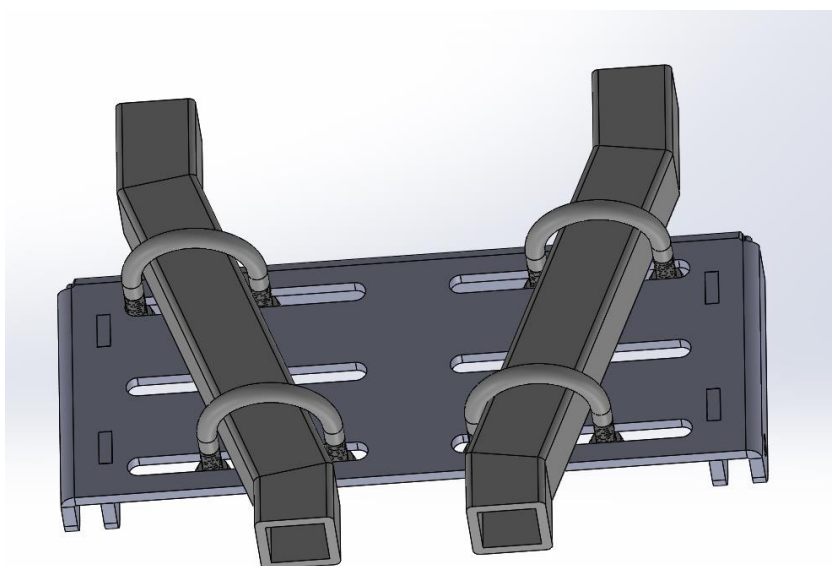

DENALI Universal ATV Plow Mount

Patent #: US8505973B2



motoalliance

22000 Industrial Blvd

Rogers, MN 55374

866.527.7637

